

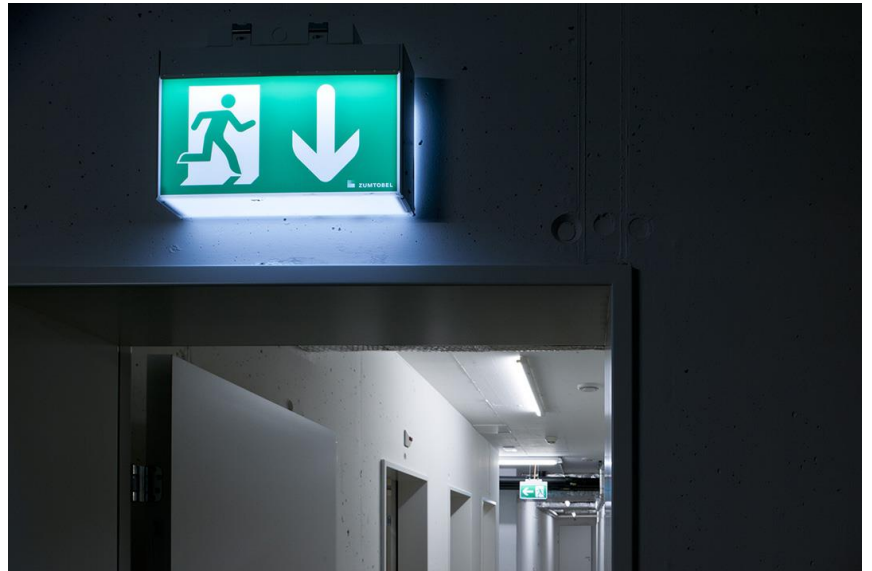

## ECOSIGN 160 P safety sign SP



- Polycarbonate opal cover with additional downwards light outlet, internal longitudinal prisms providing support illumination of escape route
- Uniform backlighting of safety sign with a luminance of more than 500 cd/m<sup>2</sup> in the white area
- Tool-free installation on base unit
- Escape sign SP-2LR, left or right direction by rotating luminaire

**An Environmental Product Declaration (EPD) is available for the following products.**

ECOSIGN 160 SP1-E002-UP

22900371

Architect: Matteo Thun